

Read the instruction before operating your shade

**Installation & Maintenance Instructions
Honeycomb Shade
Cordloop & SmartRelease™ Cordloop & Cordloop
Top Down / Day & Night**

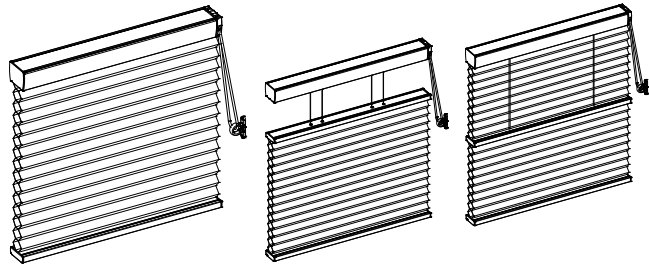

Getting Started

Remove shade from package. Save packaging until shade is installed and working to your satisfaction.

Tools:

- Power drill
- Tape measure
- Screwdriver
- Level
- Pencil



Installation Screws

Surface	Fastener
Wood	Screws (Provided)
Drywall/Plaster	Wall Anchors, Expansion Bolts (Not Provide)
Metal	Sheet Metal Screws (Not Provide)

**Check Components / Hardware
Installation Brackets**



For 25mmS & 45mmS & 45mmD

For 62mmS & 62mmD

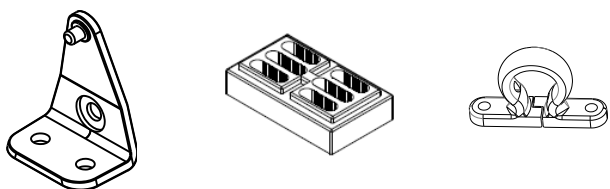

Hold Down Bracket (Optional) Spacer Block (Optional) Cord Cleat

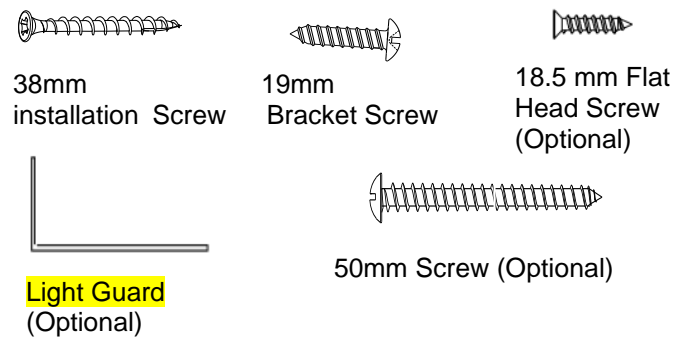

Step 1: Bracket Installation

Measure 75mm from both ends of the head rail. Mark bracket location on the mounting surface.

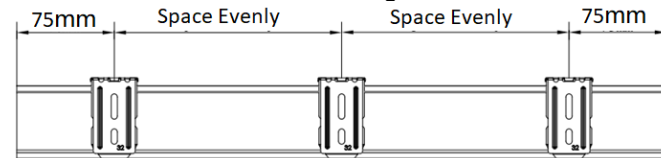

Inside Mount

For 25mmS, 45mmS & 45mmD allocate a minimum distance (L1) from wall to the front of brackets

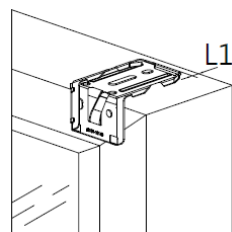

Distance	Application Condition
$L1 \geq 4mm$.With light guard front and back
$L1 \geq 2mm$.Without light guard, & with light guard at back

. For 62mm S, 62mm D, allocate a minimum distance (L1) from wall to the front of brackets

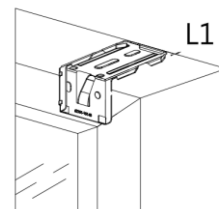

Distance	Application Condition
$L1 \geq 3mm$.With light guard front and back
$L1 \geq 1mm$.Without light guard, & with light guard at back

Use two 38mm installation screws to secure brackets. **Use wall anchors for drywall or plaster wall.**

Outside Mount

.For 25mmS, 45mmD, & 45mmS, allocate a minimum distance of 1mm from wall to the Bottom of brackets as right drawing.

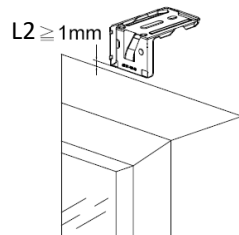

. For 62mm S, 62mm D, align the end of brackets with the top window frame as right drawing. Note: The distance should not exceed 7mm

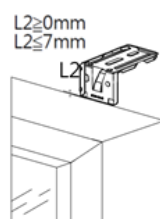

.Use two 38mm screws to attach each bracket. **Use wall anchors for drywall or plaster wall.**

Note: If spacer block is required for outside mount, please follow the following guide:

Please always make sure the raised side of the spacer block is against the bracket.



If 2pcs spacer blocks are required, please follow the illustration to attach the spacer blocks.

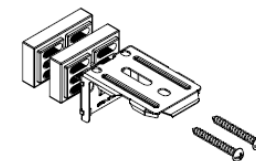

Mount the combination of the bracket and spacer block with two 38mm screws for 1 set and two 50mm screws for 2 sets spacer blocks.

The window frame protrudes from wall by 0~10mm, one spacer block is used.	
The window frame protrudes from wall 10~18mm, two spacer blocks are used.	

Step 2: Shade Installation

.Position head rail at an angle so that it is hooked to the front of the bracket. Then push it upward at the back to snap into the bracket.

▲ **For proper installation, start with attaching the front rail to the bracket.**

For easier installation of 62mmS and 62mmD, move the bottom rail of Cordloop & SmartRelease™ Cordloop, or middle rail of Cordloop TD and Day & Night a little bit off before installing the head rail.

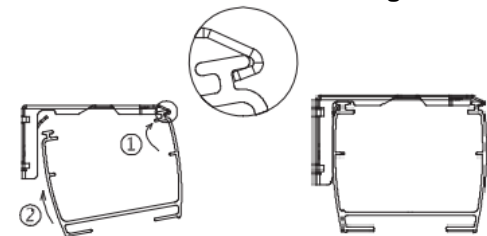

For 25mmS, 45mmD, and 45mmS

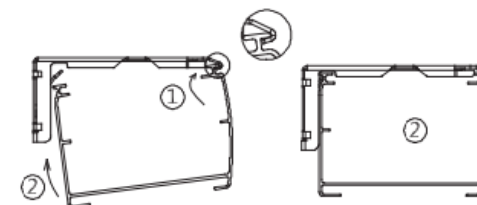

For 62mm S & 62mm D

Step 3: Install Light Guard (Optional for IM)

Please install the light guard after installation of the shade is completed.

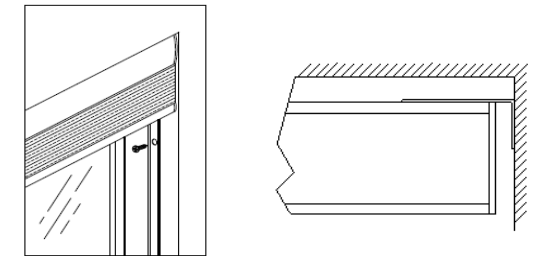

With light guard at back

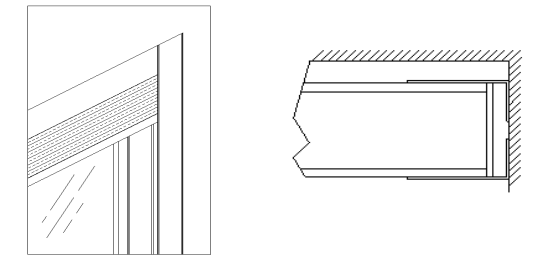

With light guard at front and back

a. The light guard is to be placed at back or front of the shade at left & right side.

Place the light guard vertically towards the bottom window frame. To avoid scraping, leave a 2mm gap between fabric stack and light guard. And then mark out the location with a pencil.

Remove the double sided tapes on the narrow side of the light guard and carefully paste the light guard to the window frame in position.

b. For better fixing the light guard to the window, use 18.5mm flat head screw to secure the light guard through the pre-drilled hole.

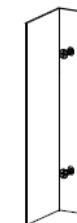

c. When light guard length (L) > 2438mm, light guard will be sliced into 2 pieces. There are two conditions as listed below.

Light guard length (L)	Short piece Light Guard Length	Long piece Light Guard Length
$2438mm < L \leq 3048mm$	610mm	L-610mm
$L > 3048mm$	L-2438mm	2438mm

When light guard sliced into 2pcs, firstly paste the longer piece of light guard vertically towards the bottom window frame, and paste the shorter piece of light guard above the longer one, the edges must be carefully aligned.

To avoid the edges from scraping the fabric, use the protective sticker to completely cover the joint of the two pieces of light guard on both front and back sides of light guard as diagram on the right.

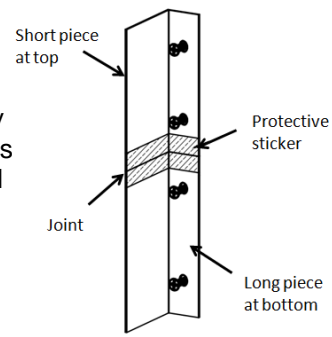

Step 4: Install the Cord Cleat

Children can strangle if the cord cleat is not installed. Always use the cord cleat to keep cords or chains out of the reach of children. Snap the cord into the Cord Cleat. Mark the position where the Cord Cleat will be installed. **The Cord Cleat shall be installed at the maximum distance possible from the control mechanism to prevent the looped pull cord(s) becoming slack.** Install the Cord Cleat with 19mm screws which must be secured into a solid surface. When positioning and installing the Cord Cleat, make sure the chain or cord is taut without stretching, twisting or crossing.

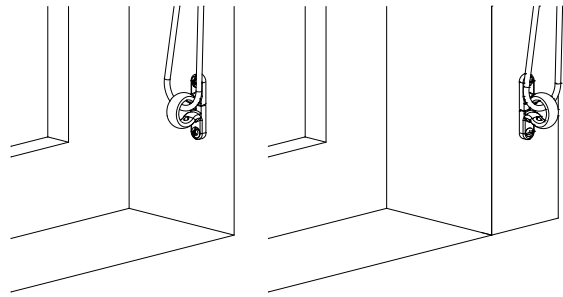

Step 5: Install Hold Down (if applicable)

A, For Hold Down Bracket.

.Use 19mm screw to secure each bracket.

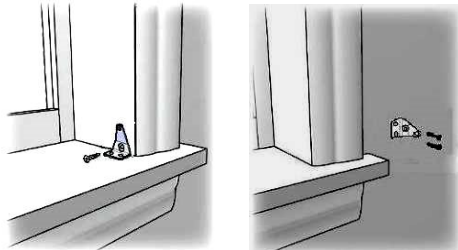

B. For Magnetic Hold Down

Use M3x15mm screw to secure the magnet catch at the below location. Make sure the magnet catch align with the pre-installed magnet on shade bottom rail.

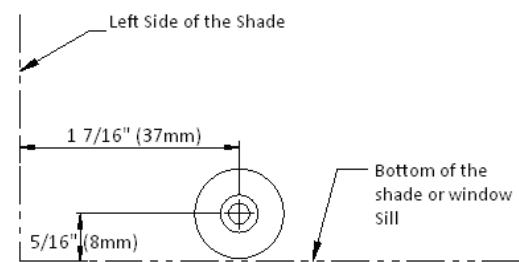

Step 6: Shade Operation

Cord Cleat must be fully tightened prior to operating the shade.

For Cordloop.

· Pull cord to operate shade. **Cord cleat must be fully tightened prior to operating the shade.**

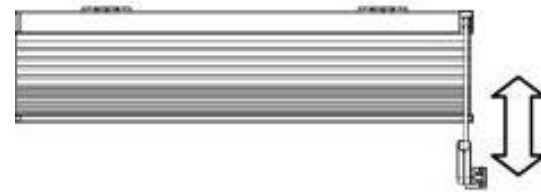

For SmartRelease™ Cordloop

Pull the front control cord to let the shade go up.

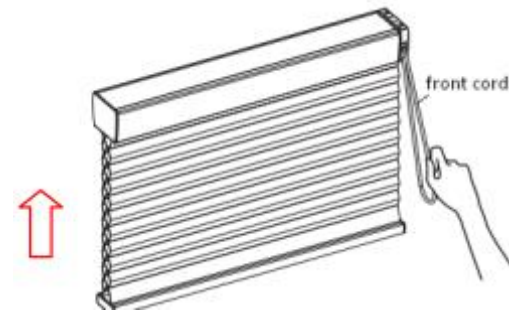

Pull the back control cord, the shade will go down automatically, till it fully close. If want to stop the shade go down, only need to pull the front control cord a little.

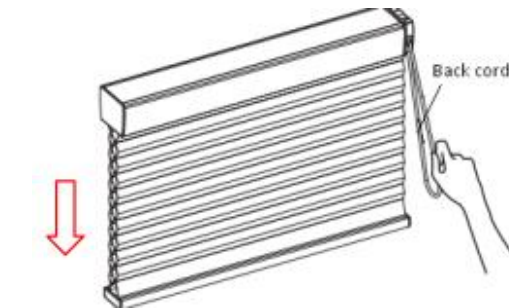

Cordloop TD/ D&N:

· Pull cord to operate shade. **Cord Cleat must be fully tightened prior to operating the shade.**

· To lower the shade as follow

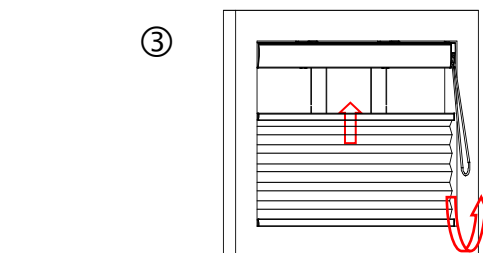
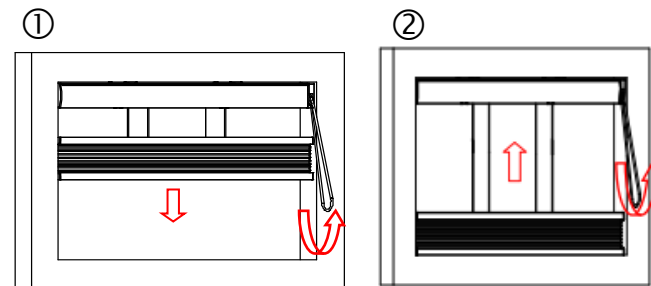

To raise the shade as follow

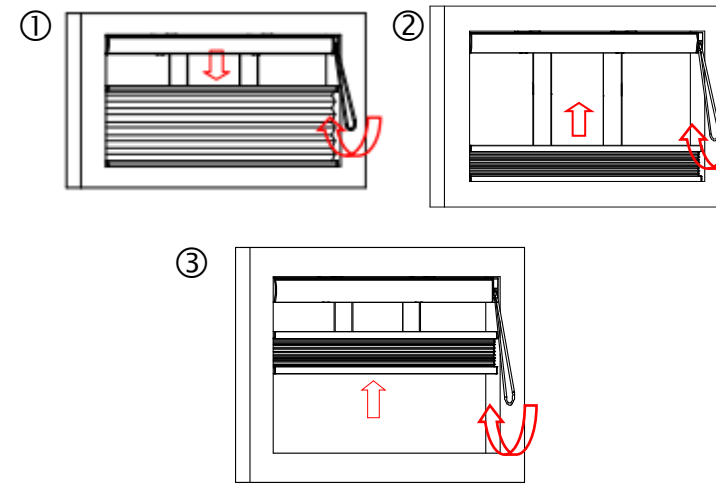

Note: the control cord cannot be too tightened / taut when installing due to its own system character. There should be no obstruction when the shade going down. Please do not play the bottom rail and control cord which may harm the shade.

Remove the Shade

.Use a flat screwdriver to insert into the center of the bracket to push up the flip on the bracket.
 .While pushing upwards, gently swing the screwdriver forward to pry the bracket off the head rail.
 .Remove the shade.

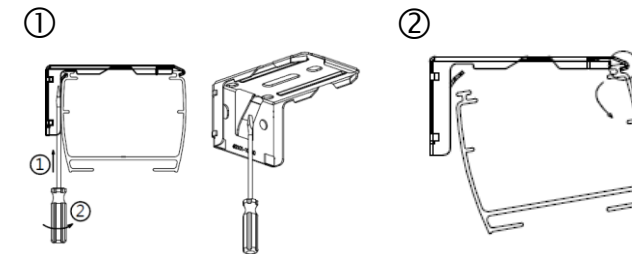

For 25mmS, 45mmD, and 45mmS

.Fully raise the shade.
 .Gently pry the bracket off the head rail with a flat screwdriver.
 .Remove the shade.

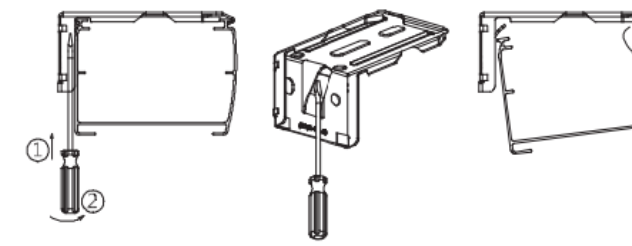

For 62mm S & 62mm D

Note

- Keep away from heat, sparks and open flame.
- Larger windows may require two people to install.
- The shade must be supported firmly during installation to prevent it falling and causing damage to people, property or the blind itself.
- Operate shade only by pulling the cord.
- The cord cleat **MUST** be installed, and tensioned correctly to comply with child safety laws. Please see the child safety instructions included for details.

Cleaning

Routine cleaning will help maintain the beauty of your shade. The shade can be cleaned by using a soft brush, vacuumed with a low suction hand-held vacuum, cleaned ultrasonically (specify that a mild solution must be used and that the head rail should never be immersed in liquid), or dampen a clean cloth with a warm water and mild detergent solution to dab the spot until it's gone (do not rub!)

Warning Label

A warning label is permanently attached to the cord. Do not remove this safety label, even after installation



To avoid creating a possible strangulation hazard for children, the corded or chained internal window covering must be installed in such a way that a loose cord or chain cannot form a loop 220mm or longer at a height of less than 1600mm above floor level.

- A cord/chain guide may be installed lower than 1600mm above floor level if the cord/chain is sufficiently secured or tensioned to prevent a loop 220mm or longer from being formed.
- If a cord/chain guide is installed lower than 1600mm above floor level, it must be designed to prevent a child from being able to remove the cord/chain.
- If a cleat is used to secure the cord, it must be at least 1600mm above floor level because a child is capable of unwinding a cord from a cleat.